

Oxer Kit - 80329

**mimSAFE**  
mimclip.mimsafe.com

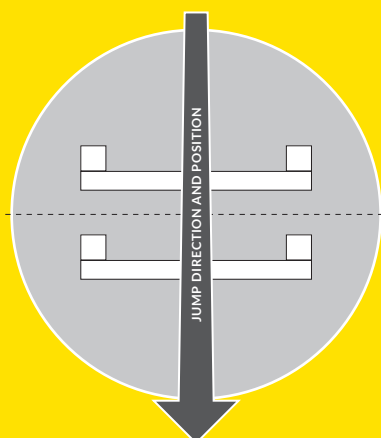
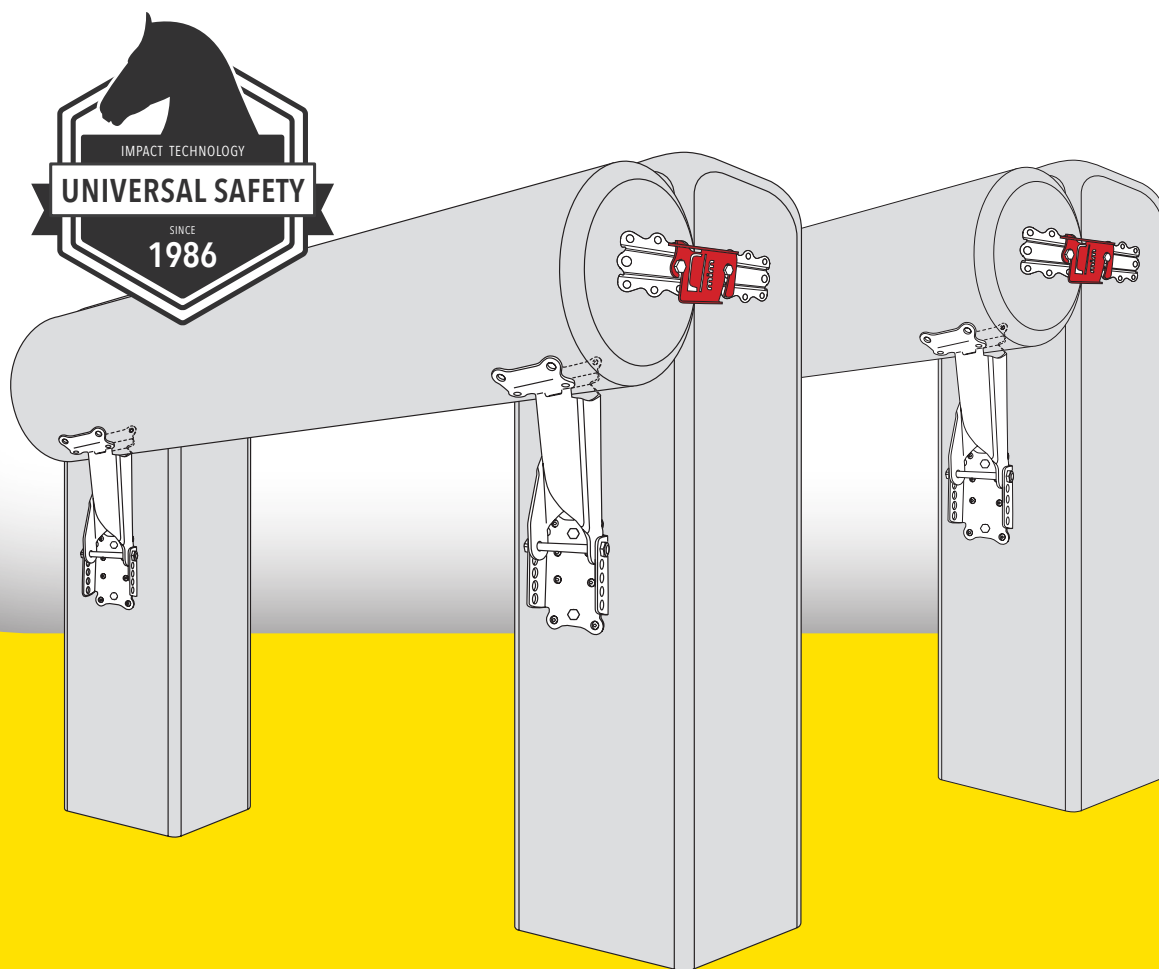

ASSEMBLY AND OPERATION INSTRUCTIONS

## OXER KIT

MIMCLIP SYSTEM



APPROVED

# INFORMATION ABOUT THE OXER KIT

The Oxer Kit has been designed and developed specifically to greatly reduce the risk of rotational falls. The most important element of this kit is that it will not break the fence or

risk injury to the horse if hit vertically. The rail is only released when impacted horizontally by the horse. The risk of a resulting rotational fall is thus reduced.

### FENCE DIMENSIONS

POST



MAXIMUM SIZE

10	inch
250	mm



MAXIMUM SIZE

10	inch
250	mm

RAIL

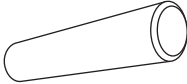

MAXIMUM LENGTH

13.1	ft
4000	mm

MAXIMUM WEIGHT

265	lb
120	kg

MAY ONLY BE EXCEEDED BY 25%



It is essential to follow the recommended instructions on the fence for the correct function. All WEIGHTS may be exceeded by no more than 25% of the relevant maximum weight as specified above. There are NO MINIMUM WEIGHTS.

For your own safety and that of others please note the following step by step advice for correct preparation and installation. It is important to ensure that you follow your own health and safety requirements when constructing this kit.

**Ensure that you have all parts of the Oxer Kit.**

**Be aware of the risk of injury when handling heavy rails, posts and the tools for mounting.**

**WARNING!**

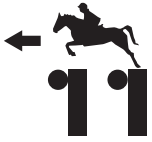

Jumping direction

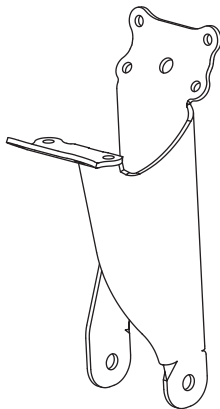
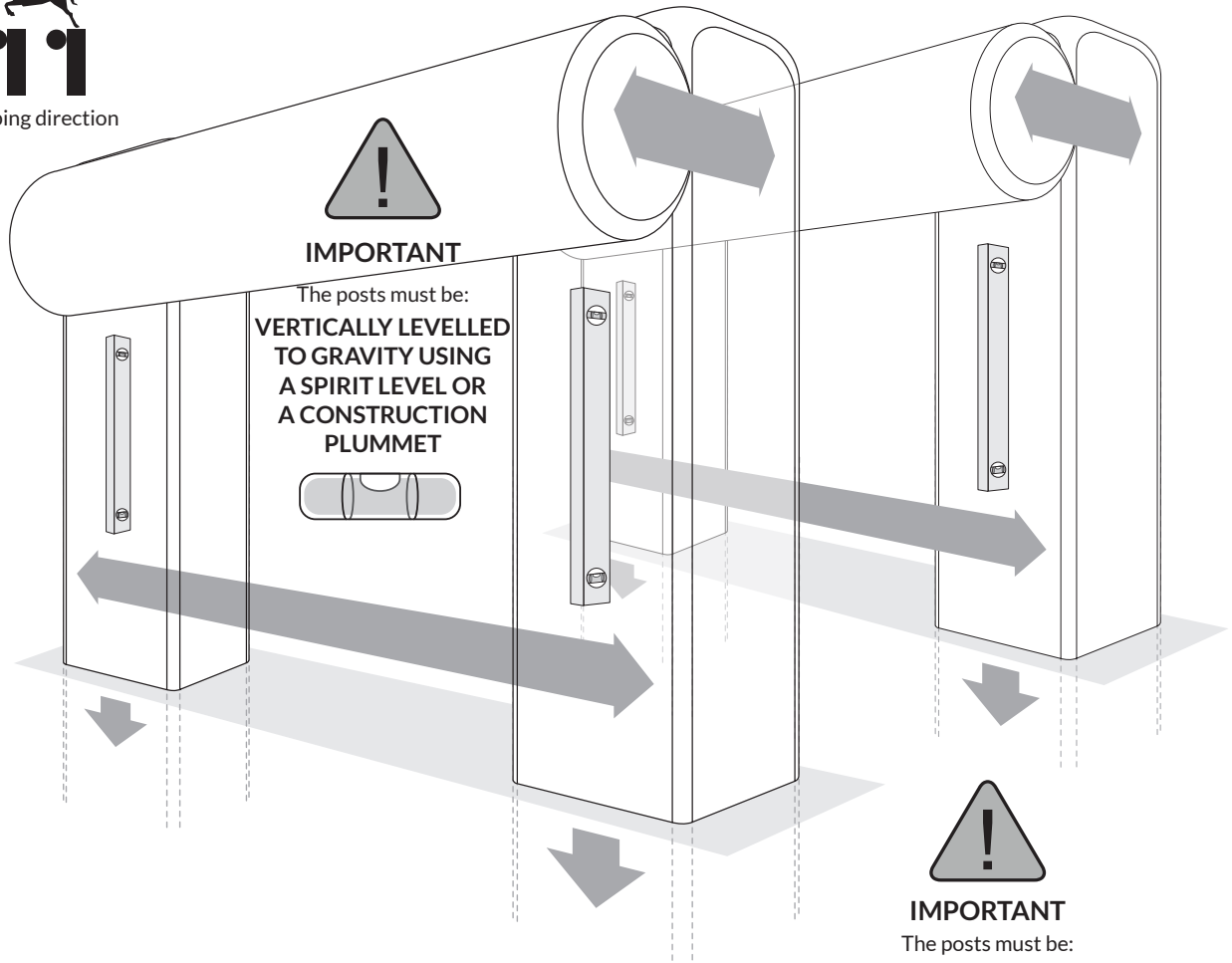

**A** F65  
Part no 4x

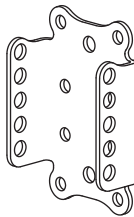

**B** F64A5  
Part no 4x

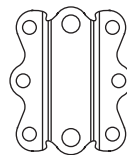

**C** F70A  
Part no 8x



**D** F18C  
Part no 12x

M-SM12x120 4X 	M-BR12x22x2s 4X 	M-MM12Ny 4X 	M-TS10X90 8X 	POST 4X  not included	RAIL 2X  not included
----------------------	------------------------	--------------------	---------------------	--------------------------------	--------------------------------

STEP  
**1**

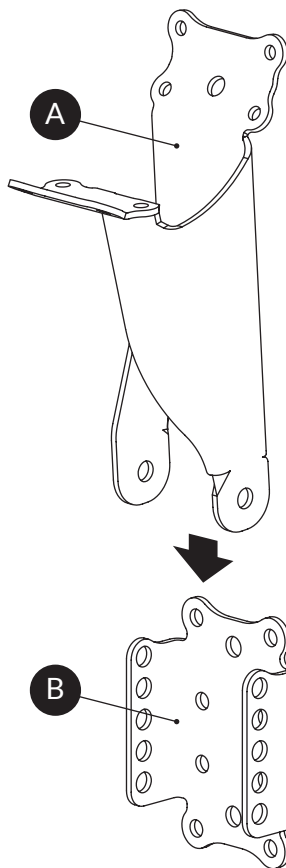

**4X**

M-SM12x120 4X	M-BR12x22x2s 4X	M-MM12Ny 4X

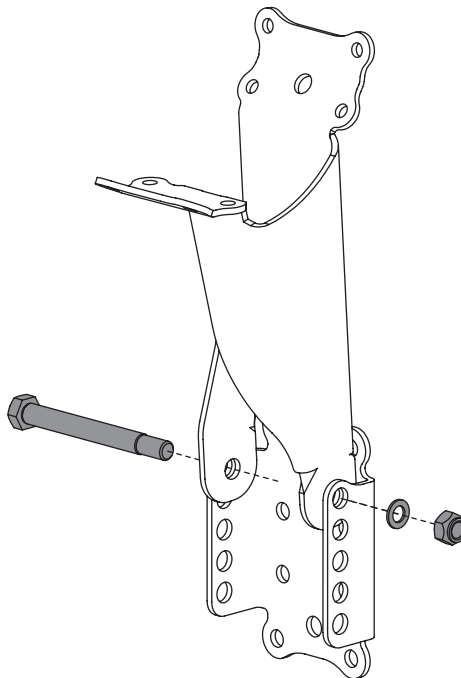

STEP  
**2**

**2X**

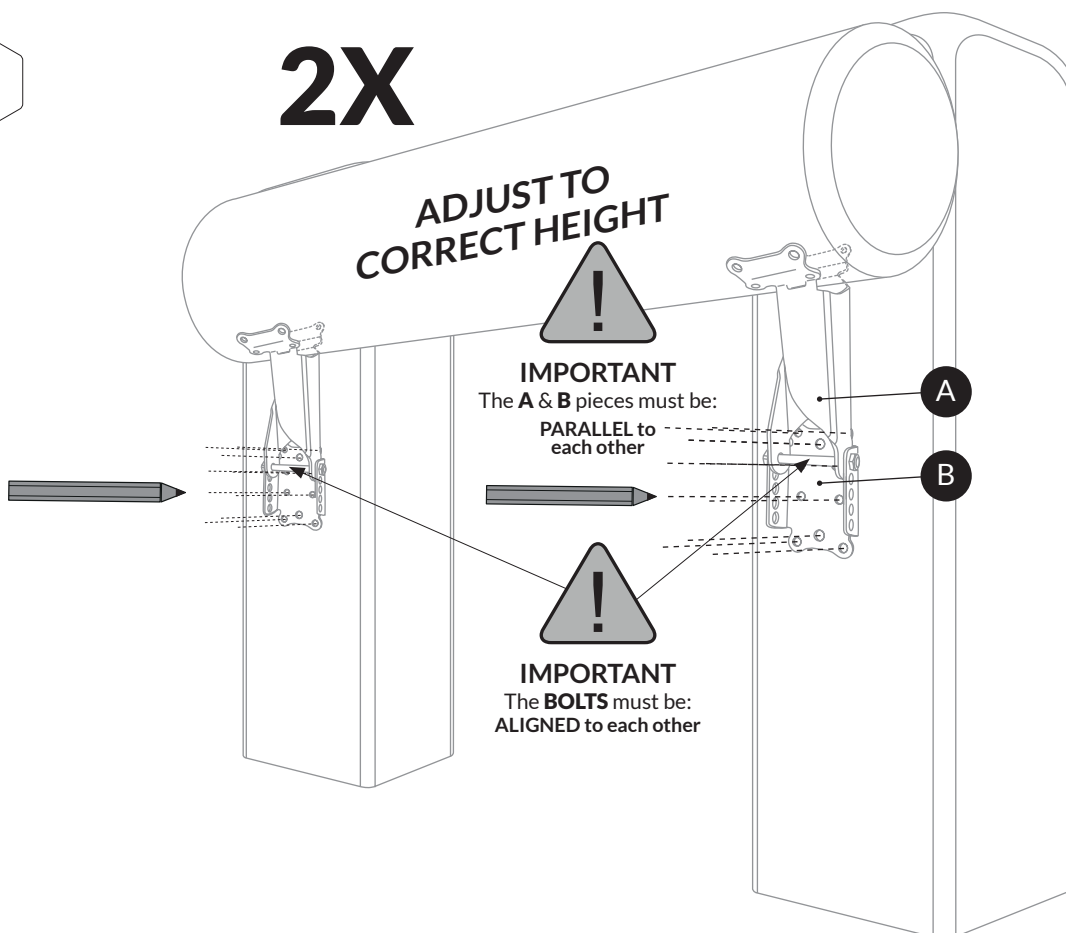

STEP  
**3**

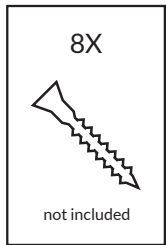
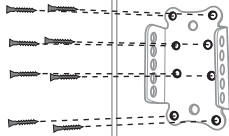

**4X**

STEP  
**3\***

\*alternative

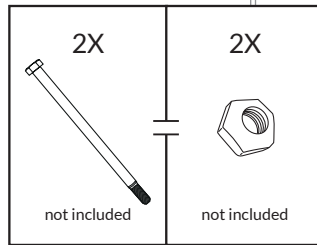
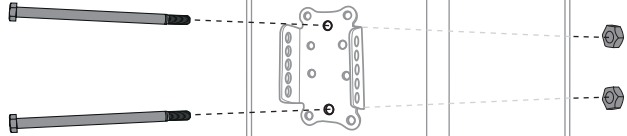

**4X**

STEP  
**4**

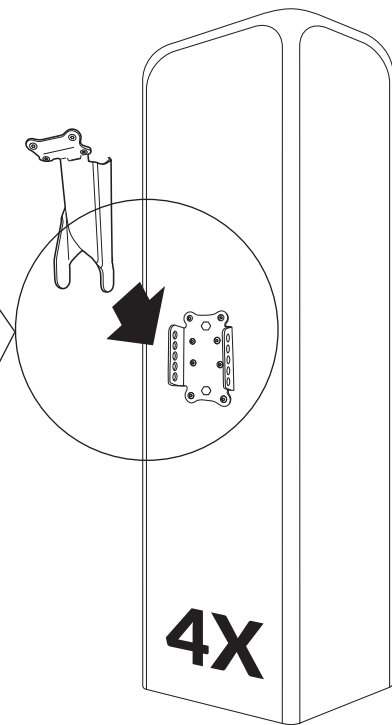
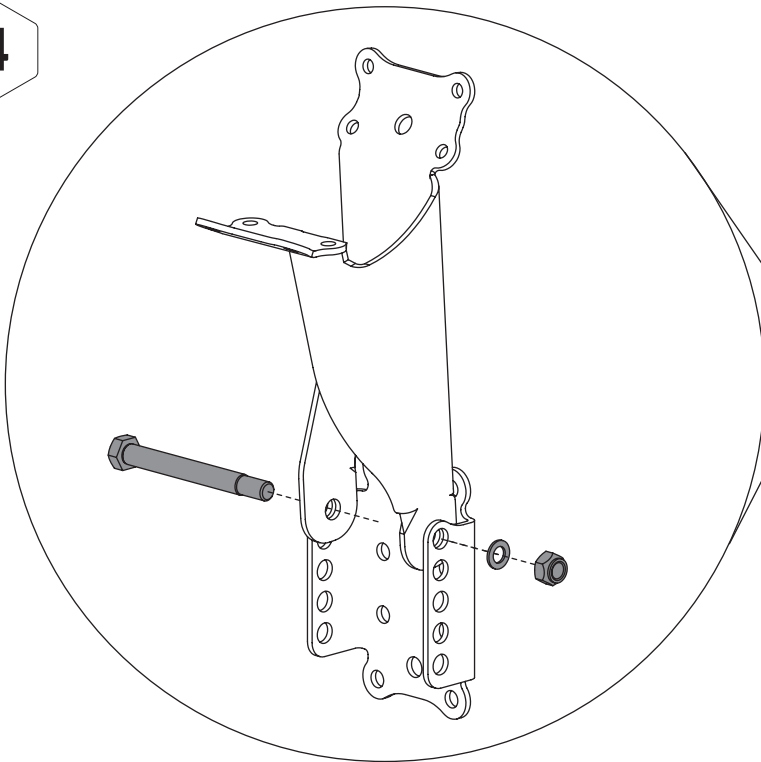

**4X**

STEP  
**5**

**2X**

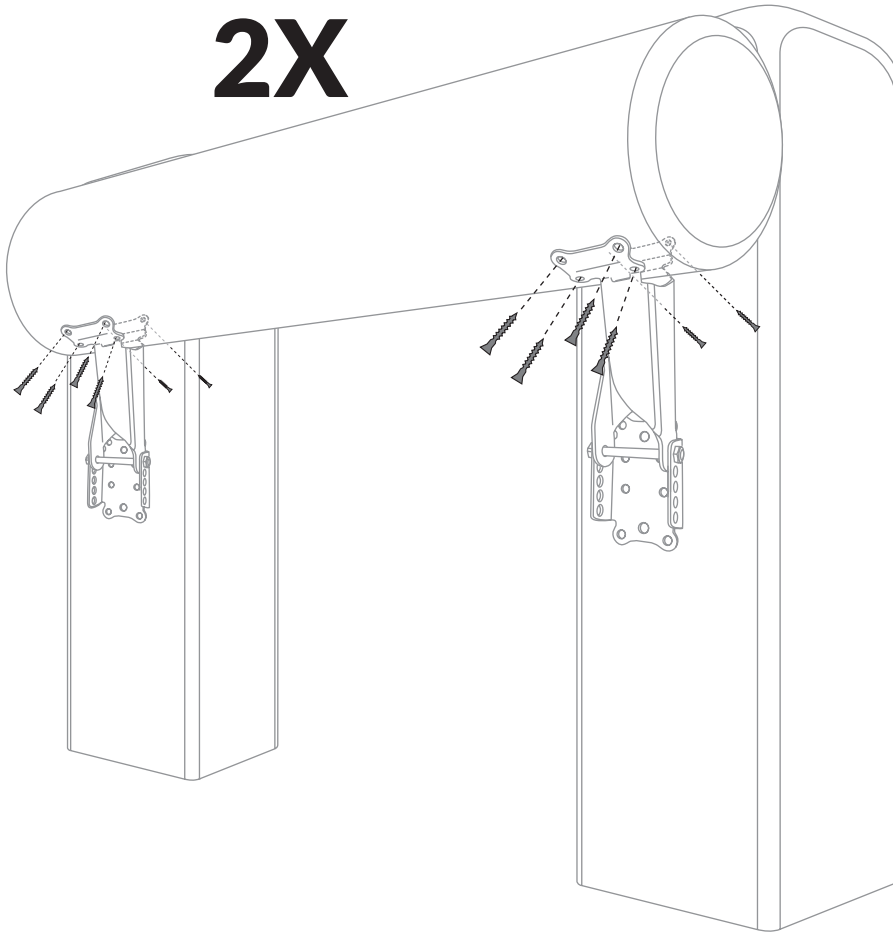

12X

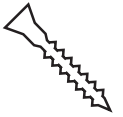

not included

STEP  
**5\***

\*alternative

**2X**

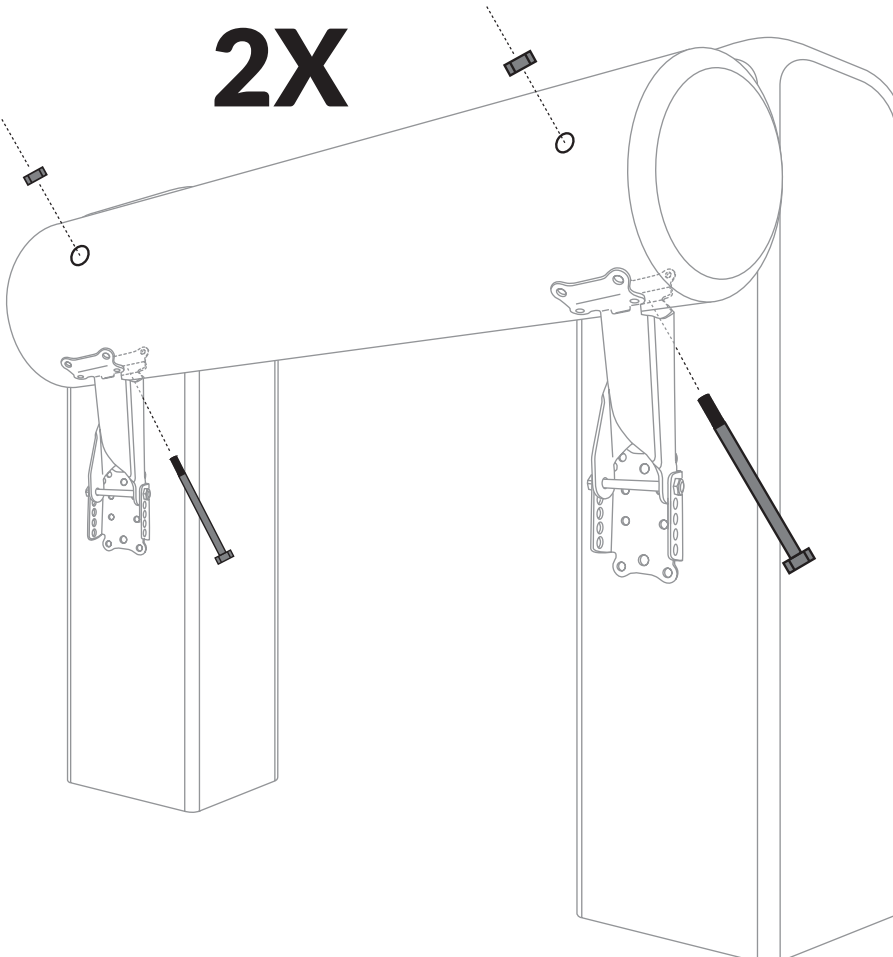

2X



not included

2X



not included

STEP  
6

4X

8X

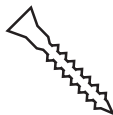

not included

MIMclip as close to  
horizontal as possible  
within  $\pm 25^\circ$  deviation

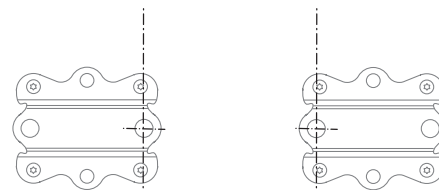

DISTANCE BETWEEN  
C PIECES



OPTIONAL  
POSITIONING OF  
C PIECES

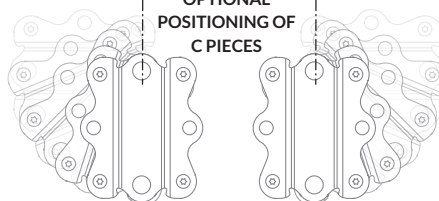

C

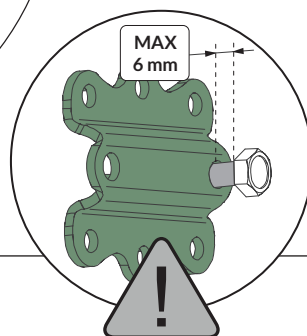

STEP  
7

4X

M-TS10X90

2X



ALTERNATIVE  
CONSTRUCTION

M10 THREAD

top view

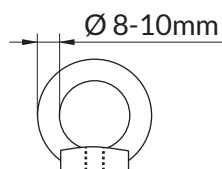

Ø 8-10mm

STEP  
8

4X

D

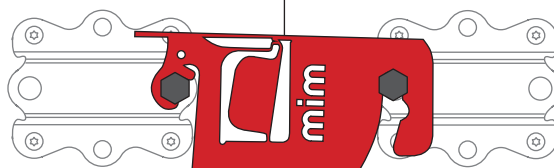
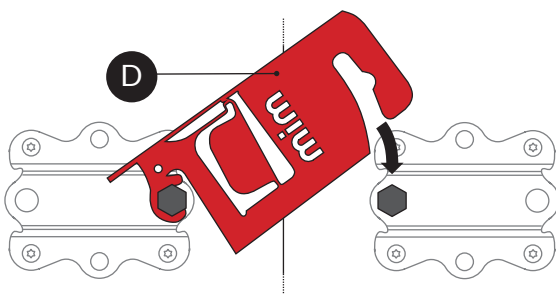

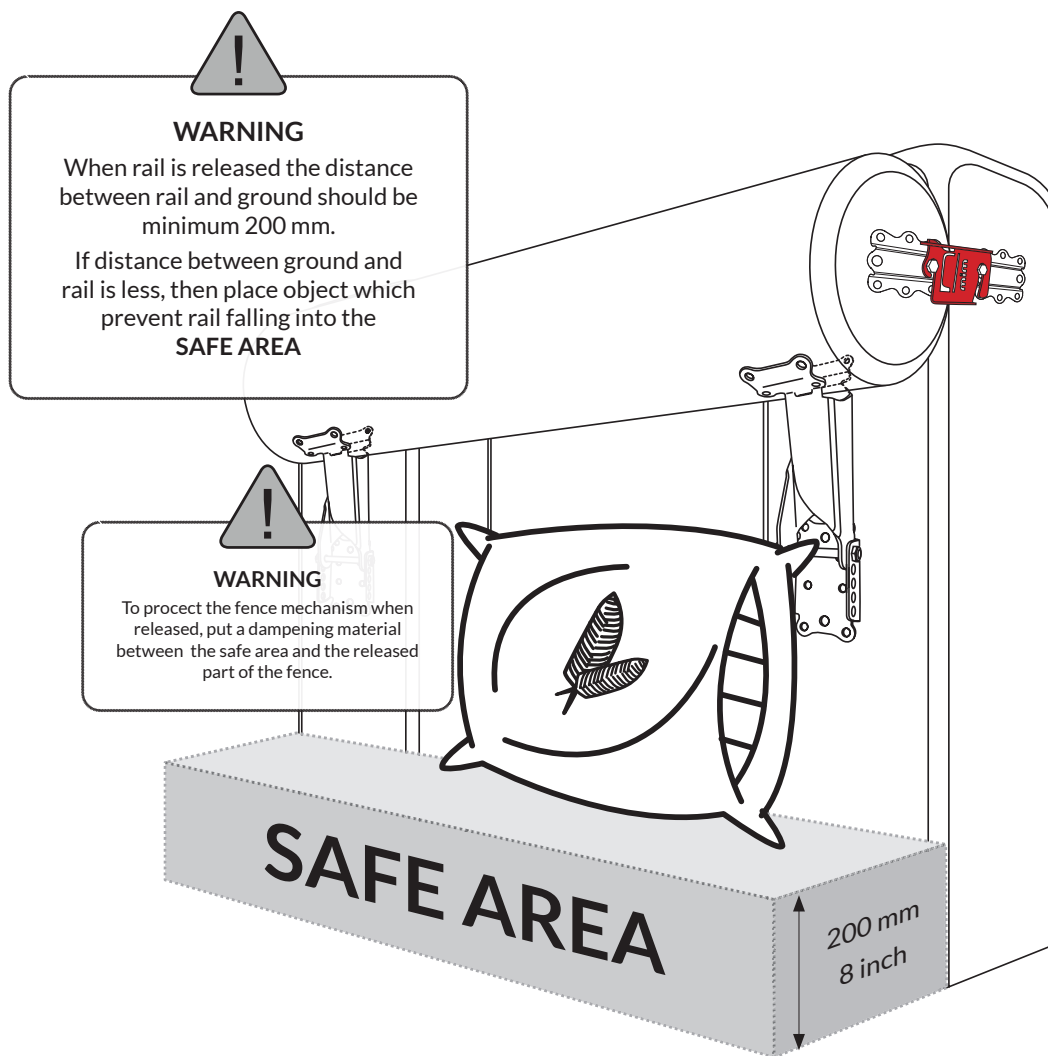

### The advantages of the Oxer Kit

1. It has been produced with safety being the first and foremost important factor.
2. Reduces the possibility of rotational falls.
3. FEI approved number FEI09SWE.
4. Controlled movement of fence during release.
5. Reconstruction time is less than 30 seconds.
6. The parts are made of powder coated steel and can be left outside, no maintenance is required.
7. The very highest quality of product from Sweden.

### The advantages of the MIMclip

The MIMclip (F18C) breaks on impact. The flag is bent when the clip is exposed to fatigue. In both cases the clip must be replaced. The top section is connected to the post with a hinge that makes the fence easy to reconstruct. This saves time, guarantees fair and correct judging for riders and contributes to the overall safety of the sport.



The flag is bent when fatigued.